

PGR-1 Turtle Safe LED Specifications



Project Name:

Catalog Number:

Type:

The **PGR-1 LED** luminaire from Visionaire incorporates our single chip LED technology; while maintaining a traditional architectural fixture form factor. The LEDs performance and life are maximized by the unique integral aluminum heat sink. It is an ideal retrofit for the high-maintenance HID fixtures of yesterday.

The LED housing is heavy duty spun aluminum with either 16, 32 or 48 LEDs. Mounting options include Universal Bolt On Arm, Yoke Mount, Knuckle Mount or Wall Mount. The Universal Bolt on Arm is available with a Quick Mount Pole Adaptor for retrofitting existing poles.

Seven optical distribution patterns are available. 590 nm diode supplied as standard.

A durable polyester powder coat finish is guaranteed for five years and is available in standard or custom colors.

The **PGR-1 LED** series is an exceptional choice for universities, shopping centers, parks and recreational areas and general site lighting.

Ordering Information

MODEL	OPTICS	LEDs	CURRENT	KELVIN	VOLTAGE	MOUNTING	FINISH	OPTIONS	OPTIONS
PGR-1	T1 Type 1	16LC	3 350mA	TS 590 nm	UNV 120-277V	UBOA Universal Bolt-On Arm	BZ Bronze	PCR-120 Photocell & Receptacle	WSC-8 Motion Sensor 8' Mounting Height
	T2 Type 2	32LC	5 530mA		8 347V	YM Yoke Mount	BK Black	PCR-208 Photocell & Receptacle	WSC-20 Motion Sensor 9-20' Mounting Height
	T3 Type 3	48LC			5 480V	WM Wall Mount	SBK Smooth Black	PCR-240 Photocell & Receptacle	WSC-40 Motion Sensor 21-40' Mounting Height
	T4 Type 4						WH White	PCR-277 Photocell & Receptacle	The WSC option will require (1) FSIR 100 remote for programming
	T5 Type 5					Round Pole Plate Adaptors (RPP) are to be ordered separately.	SWH Smooth White	PCR-480 Photocell & Receptacle	VWC Visionaire Wireless Controls Consult Factory
	T5W Type 5 Wide						GP Graphite	PER 3 Pin Photo Receptacle w/shorting cap	RPP Round Pole Plate Adaptor
	T5WR Type 5 Wide Round						GY Grey	5PINPER 5 Pin Photo Receptacle w/shorting cap Requires Dimming Driver	ROT-R Rotated Optics Right Side
							SL Silver Metallic	7PINPER 7 Pin Photo Receptacle w/shorting cap Requires Dimming Driver	ROT-L Rotated Optics Left Side
							CC Custom Color	DIM 0-10v Dimming Driver	LS Light Shield

Housing

- Heavy duty spun aluminum housing with internal heat sink for maximum heat dissipation.
- Silicone gasket is used for weather tight operation.

Mounting

- Universal Bolt On Arm - A pre-attached aluminum arm (UBOA) is supplied along with a Universal Quick Mount pole adaptor for fast and easy attachment to the pole.
- Yoke Mount - A post adaptor fits over a vertical 2 3/8" tenon secured with stainless steel hardware.
- Wall Mount - Bolt-on arm wall plate

Thermal Management

The PGR-1 series provides excellent thermal management by mounting the LEDs to the substantial heat sink within the housing. This enables the Luminaire to withstand higher ambient temperatures and driver currents without degrading LED life.

Optical System

- The highest lumen output LEDs are utilized. High-performance acrylic optics feature industry leading Type 1, 2, 3, 4, 5, 5W and 5WR optical distributions.
- Acrylic optics are impact-resistant and rated to 94 percent translucence.
- L70 life of our LEDs is rated over 100,000 hours (for 530 mA).
- The optical system qualifies as IES full cutoff to restrict light trespass, glare and light pollution for neighborhood-friendly lighting.
- 590 nm diode supplied as standard.

Quali-Guard® Finish

- The finish is a Quali-Guard® textured, chemically pretreated through a multiple-stage washer, electrostatically applied, thermoset polyester powder coat finish, with a minimum of 3-5 millimeter thickness. Finish is oven-baked at 400° F to promote maximum adherence and finish hardness.
- All finishes are available in standard and custom colors.
- Finish is guaranteed for five (5) years.

Electrical Assembly

- The PGR-1 LED series is supplied with a choice of 350 or 530 mA high-performance LED drivers that accept 120v thru 480v, 50 Hz to 60 Hz, input.
- Power factor of 90%.
- Rated for -40°C operations.
- 10kV Surge Protector supplied as standard.
- THD less than or equal to 20%

Warranty

- Five (5) year Limited Warranty on electrical components
 - Five (5) year on finish.
- For full warranty information, please visit www.visionairelighting.com.

Options

- Photocell & Receptacle
- Photocell Receptacle
- WattStopper FSP-211 Motion Sensor
- 0-10 Volt Dimming Driver
- Emergency Battery Pack
- Wireless Controls
- Round Pole Plate Adapter
- Rotated Optics

Listings

- PGR-1 is cUL listed, suitable for wet locations
- IP65 Rated
- Powder Coated Tough™
- DLC Listed
- IDA Certification
- Turtle Safe















DesignLights Consortium (DLC) qualified Product. Some configurations of this product family may not be DesignLights Consortium (DLC) listed, please refer to the DLC qualified products list to confirm listed configurations. <http://www.designlights.org/> 3000K must be selected for IDA certification.

Motion Sensor Default Setting									
Type	High Mode	Low Mode	Time Delay	Cut off Delay	Sensitivity	Hold Off Setpoint	Photocell On/Off	Ramp Up Time	Fade Down Time
WSC - Default	10V	1V	5 Min	1 Hour	Max	Disabled	Disabled	Disabled	Disabled
WSC Range	0-10V	0-9.8V	5-30 Min	1-5 Hours	Low, Med, Max	1-250FC	1-250FC	1-60 Dec	1-60 Dec

PGR-1 Turtle Safe LED Specifications

Photometric Optical Summary

T1 Type 1	T2 Type 2	T3 Type 3	T4 Type 4	T5 Type 5	T5W Type 5 Wide	T5WR Type 5 Wide Round
						
EPA Data	 0.70	 1.08	 1.4	 1.56	 1.78	 1.56

Dimensions

Width:	PGR-1 16.0"
Depth:	PGR-1 5.0"
Height:	PGR-1 5.0"
Overall Height:	PGR-1 0.0"
Weight:	20 LBS

PGR-1 Turtle Safe (590 nm) LUMEN DATA									
# LEDs	Current (mA)	T1	T2	T3	T4	T5	T5W	T5WR	Wattage
16	350	517	478	476	467	523	472	473	18
	530	744	689	686	672	753	680	681	26
32	350	1094	1012	1008	1057	1107	1000	1000	35
	530	1566	1449	1443	1415	1585	1431	1432	52
48	350	1639	1517	1511	1467	1659	1498	1499	53
	530	2197	2033	2025	1985	2224	2008	2010	78

PGR-1 Turtle Safe (590 nm) LPW DATA									
# LEDs	Current (mA)	T1	T2	T3	T4	T5	T5W	T5WR	Wattage
16	350	29	27	26	26	29	26	26	18
	530	29	26	26	26	29	26	26	26
32	350	31	29	29	30	32	29	29	35
	530	30	28	28	27	30	28	28	52
48	350	31	29	29	28	31	28	28	53
	530	28	26	26	25	29	26	26	78

PGR-1 Turtle Safe (590 nm) BUG DATA																							
# LEDs	Current (mA)	T1			T2			T3			T4			T5			T5W			T5WR			Wattage
		B	U	G	B	U	G	B	U	G	B	U	G	B	U	G	B	U	G	B	U	G	
16	350	1	0	1	0	0	1	0	0	1	0	0	1	3	0	1	3	0	1	1	0	1	18
	530	1	0	1	1	0	1	0	0	1	1	0	1	1	0	0	1	0	1	1	0	0	26
32	350	1	0	1	1	0	1	0	0	1	0	0	1	1	0	0	1	0	1	1	0	0	35
	530	2	0	2	1	0	1	1	0	1	1	0	1	1	0	0	2	0	1	1	0	1	52
48	350	2	0	2	1	0	1	1	0	1	1	0	1	2	0	0	2	0	1	2	0	1	53
	530	2	0	2	1	0	2	1	0	1	1	0	1	2	0	1	2	0	1	2	0	1	78

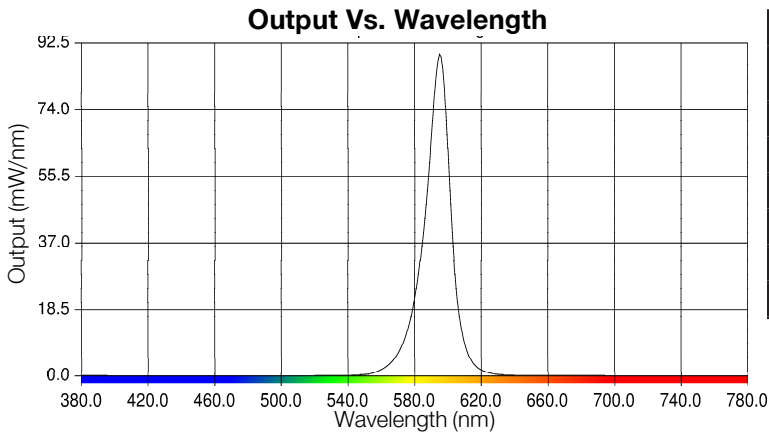

PGR-1 Turtle Safe - ELECTRICAL LOAD (A)							
Ordering Nomenclature	System Watts	120	208	240	277	347	480
PGR-1-T5W-16LC-3	18	0.15	0.09	0.08	0.06	0.05	0.04
PGR-1-T5W-16LC-5	26	0.22	0.13	0.11	0.09	0.07	0.05
PGR-1-T5W-32LC-3	35	0.29	0.17	0.15	0.13	0.10	0.07
PGR-1-T5W-32LC-5	52	0.43	0.25	0.22	0.19	0.15	0.11
PGR-1-T5W-48LC-3	53	0.44	0.25	0.22	0.19	0.15	0.11
PGR-1-T5W-48LC-5	78	0.65	0.38	0.33	0.28	0.22	0.16

PGR-1 Turtle Safe LED Specifications

Spider Mount Detail



Arm Mount Assembly Drawing

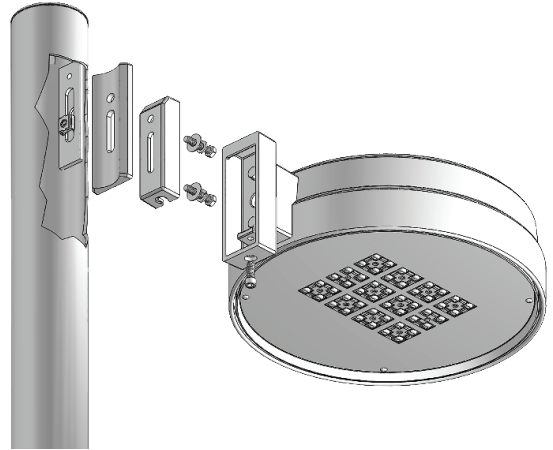

Round Pole Plate Adapter order separately.

PGR UBOA Assembly Drawing

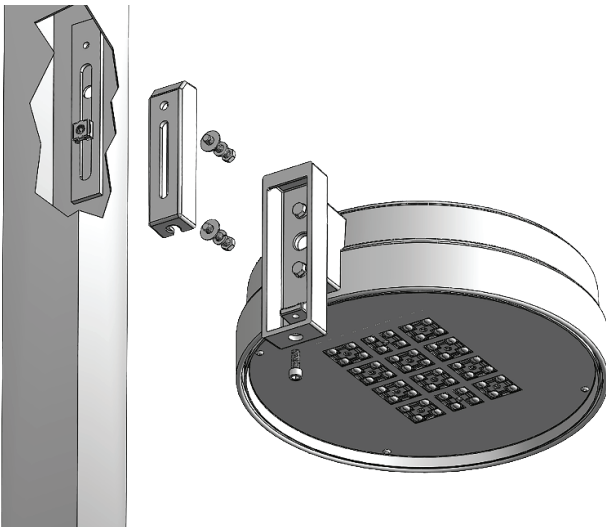

Round Pole Plate Adapter order separately.

PGR Wall Mount Drawing

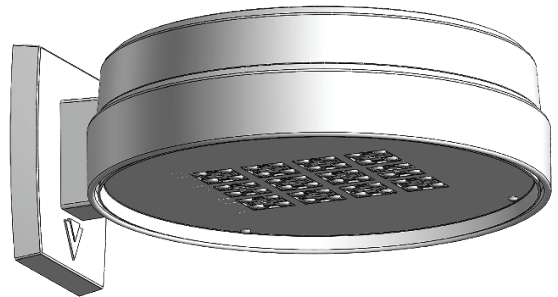

Arm Mount Drill Diagram

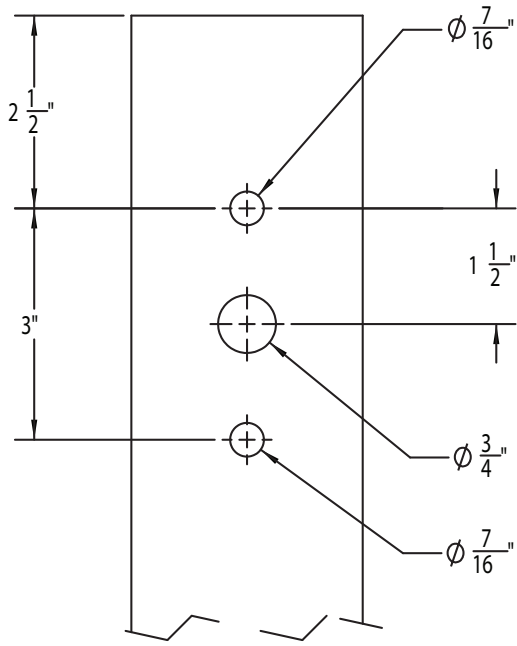

UBOA Drill Diagram

