

VMX-II Wildlife Certified LED Specifications



Project Name:

Catalog Number:

Type:

The **VMX-II LED** Series offers clean, functional styling that is defined by its sleek low profile design and rugged construction. It combines the latest LED technology, advanced LED thermal management and provides outdoor lighting that is both energy efficient and aesthetically pleasing.

The LED's performance and the driver's life are maximized by enclosing them in two separate cast aluminum housings. Easy tool-less access for mounting and maintenance.

The LED light assemblies come with 48 to 96 LEDs. Eight optical distribution patterns are available. 590 nm diode supplied as standard.

A durable polyester powder coat finish is guaranteed for five years; and is available in standard or custom colors.

The **VMX-II LED** series is an exceptional choice for commercial parking lots, office complexes, architectural projects, and other general lighting projects.

Ordering Information

MODEL	OPTICS	LEDs	CURRENT	KELVIN	VOLTAGE	MOUNTING	FINISH	OPTIONS	OPTIONS	OPTIONS
VMX-II	T1 Type 1	48LC	3 350mA	TS 590 nm	UNV 120-277V	AM Arm Mount	BZ Bronze	PCR-120 PCR-208	UMAP Universal Mast arm fitter	UPMA-S Universal Square Pole Mount Adaptor
	T2 Type 2	64LC	5 530mA		8 347V	SAM Straight Arm Mount W/ Terminal Block (New Construction)	BK Black	PCR-240 PCR-277 PCR-347	ECLS Egg Crate Louver Shield	UPMA-R Universal Round Pole Mount Adaptor
	T3 Type 3	80LC			5 480V		SBK Smooth Black	PCR-480 Photocell & Receptacle	ADJLS Adjustable Louver Light Shield	BAWP Cast Wall Plate
	T4 Type 4	96LC				UAM Universal Arm W/ Terminal Block Mount (Retrofit)	WH White	PER	BD Barn Door Shield	ROT-R Rotated Optics Right Side
	T4A Type 4 Automotive					MAF Mast Arm Fitter	SWH Smooth White	5PINPER 7PINPER 3, 5, or 7 Pin Photo Receptacle w/shorting cap Requires Dimming Driver		ROT-L Rotated Optics Left Side
	T5 Type 5					KM Knuckle Mount	GP Graphite			CLS Backside cutoff shield * Not to be used with KM
	T5W Type 5 Wide					WM Wall Mount *Requires BAWP	GY Grey	DIM 0-10v Dimming Driver		RCLS Rightside cutoff shield * Not to be used with KM
	T5WR Type 5 Wide Round					AWM Adjustable Wall Mount *Round Pole Plate Adaptors (RPP) are to be ordered separately. *BAWP to be ordered separately	SL Silver Metallic CC Custom Color	RPP-3" RPP-4" RPP-5" Round Pole Plate Adaptor		LCLS Leftside cutoff shield * Not to be used with KM
								VWC Visionaire Wireless Controls *Consult Factory		HSS Customizable House shield

Heatsink

Cast aluminum heatsink with integral cooling fins for thermal management.

Mounting Arm/Driver Compartment

- Durable two-piece die cast aluminum driver compartment utilizes a tool-less push button latch for ease of maintenance and sealed with a one-piece silicone gasket.
- Meets ANSI C136.31-2010 1.5G Vibration Standards.

Thermal Management

- The VMX-II series provides excellent thermal management by mounting the LEDs to the substantial heat sink of the housing. This enables the Luminaire to withstand higher ambient temperatures and driver currents without degrading LED life.
- The L70 test determines the point in an LEDs life when it reaches 70 percent of its initial output.
- The VMX-II series LEDs have been determined to last 100,000+ hours in 25° C environments when driven at 350 mA.

Optical System

- The highest lumen output, LEDs are utilized in the VMX series.
- IES distribution Types FM, FN, 1, 2, 3, 4, T4, 5, 5W and 5WR are available.
- The optical system qualifies as IES full cutoff to restrict light trespass, glare and light pollution.
- 590 nm diode supplied as standard.

Quali-Guard® Finish

- The finish is a Quali-Guard® textured, chemically pretreated through a multiple-stage washer, electrostatically applied, thermoset polyester powder coat finish, with a minimum of 3-5 millimeter thickness. Finish is oven-baked at 400° F to promote maximum adherence and finish hardness.
- All finishes are available in standard and custom colors.
- Finish is guaranteed for five (5) years.

Electrical Assembly

- The VMX-II LED series is supplied with a choice of 350 or 530 mA high-performance LED drivers that accept 120v thru 480v, 50 Hz to 60 Hz, input.
- Power factor of 90%.
- Rated for -40°C operations.
- 10 kV surge protector supplied as standard.
- Terminal block supplied as standard.

Warranty

- Five (5) year Limited Warranty on entire system, including finish. For full warranty information, please visit visionairelighting.com.

Options

- Photocell & receptacle
- Photo receptacle
- Round pole plate adapter
- Cast Wall Plate
- 0-10v Dimming Driver
- Motion Sensor
- Wireless Control
- Universal Pole Mount Adaptor

Listings

- The VMX-II Series is cUL Listed
- IP65 Rated
- Powder Coated Tough™
- IDA Certification
- Turtle Safe
- Certified Wildlife Lighting



The Wildlife Lighting Program was developed by the Department of the Interior's U.S. Fish and Wildlife Service and the Florida Fish and Wildlife Conservation Commission to address light pollution issues in ecologically sensitive areas while ensuring human safety and security.



Motion Sensor Default Setting									
Type	High Mode	Low Mode	Time Delay	Cut off Delay	Sensitivity	Hold Off Setpoint	Photocell On/Off	Ramp Up Time	Fade Down Time
WSC - Default	10V	1V	5 Min	1 Hour	Max	Disabled	Disabled	Disabled	Disabled
WSC Range	0-10V	0-9.8V	5-30 Min	1-5 Hours	Low, Med, Max	1-250FC	1-250FC	1-60 Dec	1-60 Dec

VMX-II Wildlife Certified LED Specifications

Photometric Optical Summary

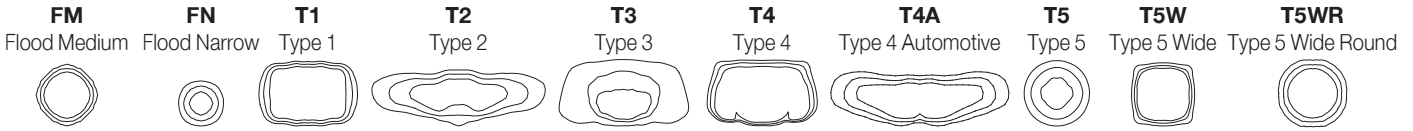

EPA Data						
	0.75	1.47	1.5	2.22	2.1	2.22

Dimensions

Width: VMX-II 15.5"

Depth: VMX-II 29"

Height: VMX-II 4.0"

Overall Height: VMX-II 10.75"

Weight: 49 LBS

Drilling Template for (AM) and (SAM)

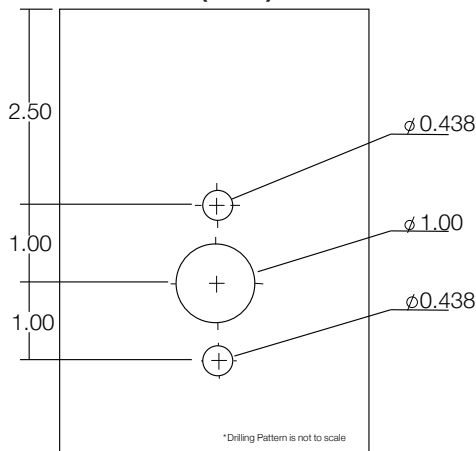

Drilling Template for (UAM)

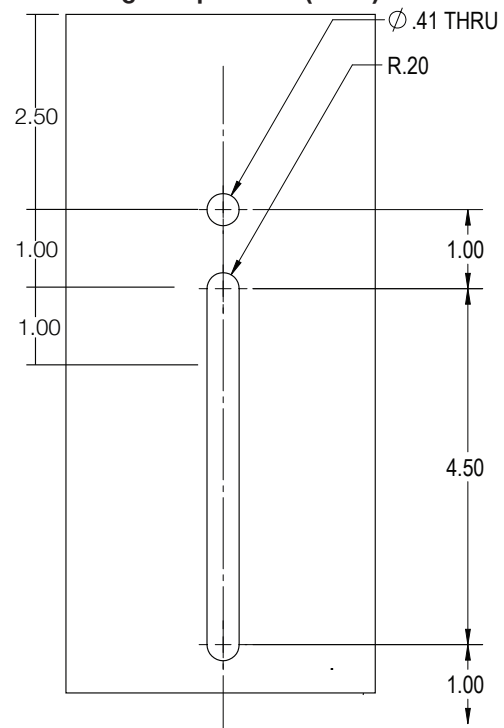

VMX-II Wildlife Certified TS (590 nm) LUMEN DATA												
# LEDs	Current (mA)	FM	FN	T1	T2	T3	T4	T4A	T5	T5W	T5WR	Watts
48	350	1704	1766	1679	1587	1664	1606	1682	1724	1684	1652	52
	530	2286	2369	2253	2129	2232	2155	2256	2313	2260	2216	78
64	350	2170	2249	2138	2021	2119	2046	2141	2196	2145	2103	70
	530	3208	3325	3161	2988	3132	3024	3166	3246	3171	3110	107
80	350	2684	2781	2644	2499	2620	2530	2648	2715	2652	2601	87
	530	3879	4020	3822	3612	3787	3656	3828	3924	3834	3760	132
96	350	3197	3313	3150	2977	3121	3014	3155	3234	3160	3099	104
	530	4550	4714	4483	4236	4441	4289	4489	4603	4497	4410	157

VMX-II Wildlife Certified TS (590 nm) LPW DATA												
# LEDs	Current (mA)	FM	FN	T1	T2	T3	T4	T4A	T5	T5W	T5WR	Watts
48	350	33	34	32	31	32	31	32	33	32	32	52
	530	29	30	29	27	29	28	29	30	29	28	78
64	350	31	32	31	29	30	29	31	31	31	30	70
	530	30	31	30	28	29	28	30	30	30	29	107
80	350	31	32	30	29	30	29	30	31	30	30	87
	530	29	30	29	27	29	28	29	30	29	28	132
96	350	31	32	30	29	30	29	30	31	30	30	104
	530	29	30	29	27	28	27	29	29	29	28	157

VMX-II Wildlife Certified TS (590 nm) BUG DATA																																			
# LEDs	Current (mA)	FM			FN			T1			T2			T3			T4			T4A			T5			T5W			T5WR			Watts			
		B	U	G	B	U	G	B	U	G	B	U	G	B	U	G	B	U	G	B	U	G	B	U	G	B	U	G							
48	350	2	0	2	2	0	0	1	0	1	1	0	1	1	0	1	1	0	1	1	0	1	1	0	1	1	0	1	1	0	1	1	0	1	52
	530	2	0	1	2	0	1	1	0	1	1	0	1	1	0	1	1	0	1	1	0	1	1	0	1	2	0	1	2	0	1	2	0	1	78
64	350	2	0	0	2	0	1	1	0	1	1	0	1	1	0	1	1	0	1	1	0	1	1	0	1	2	0	1	1	0	1	1	0	1	70
	530	3	0	1	3	0	1	2	0	2	1	0	1	1	0	1	1	0	1	1	0	1	2	0	1	2	0	1	2	0	1	2	0	1	107
80	350	3	0	1	3	0	1	1	0	1	1	0	1	1	0	1	1	0	1	1	0	1	1	0	1	2	0	1	2	0	1	2	0	1	87
	530	3	0	1	3	0	1	2	0	2	1	0	1	1	0	1	1	0	1	1	0	1	2	0	1	3	0	1	2	0	1	2	0	1	132
96	350	3	0	1	3	0	1	2	0	2	1	0	1	1	0	1	1	0	1	1	0	1	2	0	1	2	0	1	2	0	1	2	0	1	104
	530	3	0	1	3	0	1	2	0	2	1	0	1	1	0	1	1	0	1	1	0	1	2	0	1	3	0	1	3	0	1	3	0	1	157

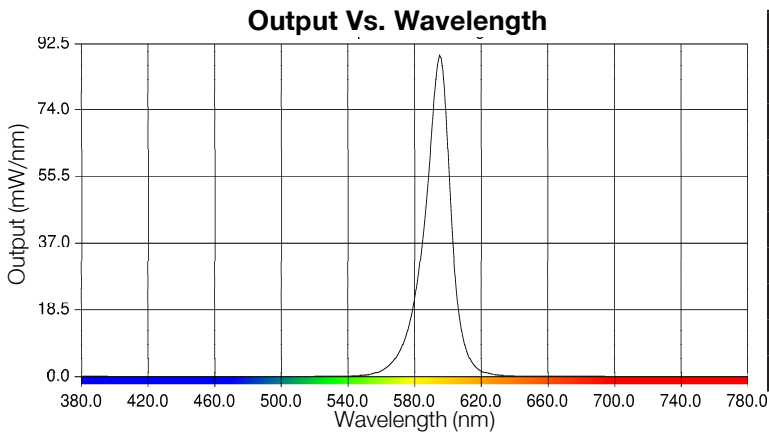

VMX-II Wildlife Certified - ELECTRICAL LOAD (A)							
Ordering Nomenclature	System Watts	120	208	240	277	347	480
VMX-II-T5-48LC-3	52	0.43	0.25	0.22	0.19	0.15	0.11
VMX-II-T5-48LC-5	78	0.65	0.38	0.33	0.28	0.22	0.16
VMX-II-T5-64LC-3	70	0.58	0.34	0.29	0.25	0.20	0.15
VMX-II-T5-64LC-5	107	0.89	0.51	0.45	0.39	0.31	0.22
VMX-II-T5-80LC-3	87	0.73	0.42	0.36	0.31	0.25	0.18
VMX-II-T5-80LC-5	132	1.10	0.63	0.55	0.48	0.38	0.28
VMX-II-T5-96LC-3	104	0.87	0.50	0.43	0.38	0.30	0.22
VMX-II-T5-96LC-5	157	1.31	0.75	0.65	0.57	0.45	0.33